

Pôdorys: Prízemie, obchodné priestory, TOP001/3; 100 m²

DODÁVKA NÁJONICA: technické vybavenie, plátno, projektor, reflektory, kamera

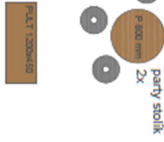

DODÁVKA NÁJONICA: party stolk



DODÁVKA PRENAJIMATELE:

11x STOL 1400x700
22x STOULČKA KONF.

8x SKRINIA
800x800x2000
(podľa 6x, žehliková 2x)

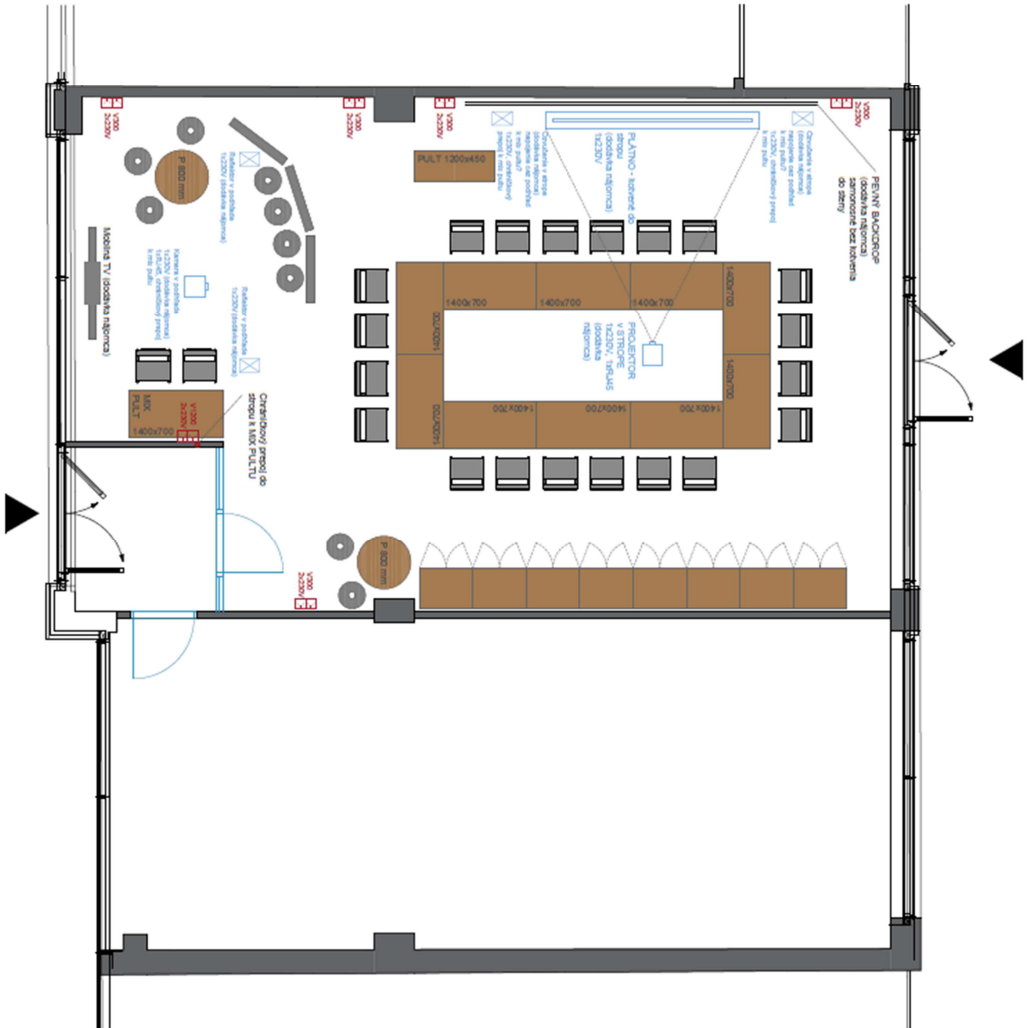

SPACE PLAN

EUROPEUM,
Ground floor

DRAWING NUMBER 01
FORMAT A3
DATE 13/10/22

REVISION 03

Pôdorys: 4. poschodie, kancelárske priestory, "TOP 401" a "TOP 402" ; 706,15 m²



TENANT AREA: 706,15 sqm

- CABINET W90-H120-D45 cm
- CABINET W90-H200-D45 cm



SPACE PLAN

EUROPEUM,
4th floor

DRAWING NUMBER 01
FORMAT A3
DATE 11/09/22

REVISION 04



Pôdorys: 5. poschodie, kancelárske priestory, "TOP 501" a "TOP 502/1"; **597,11 m²**



TENANT AREA: 597,11 sqm



SPACE PLAN

EUROPEUM,
5th floor

DRAWING NUMBER 02
FORMAT A3
DATE 11/09/22

REVISION 04

